

GLOBAL SALES NETWORK

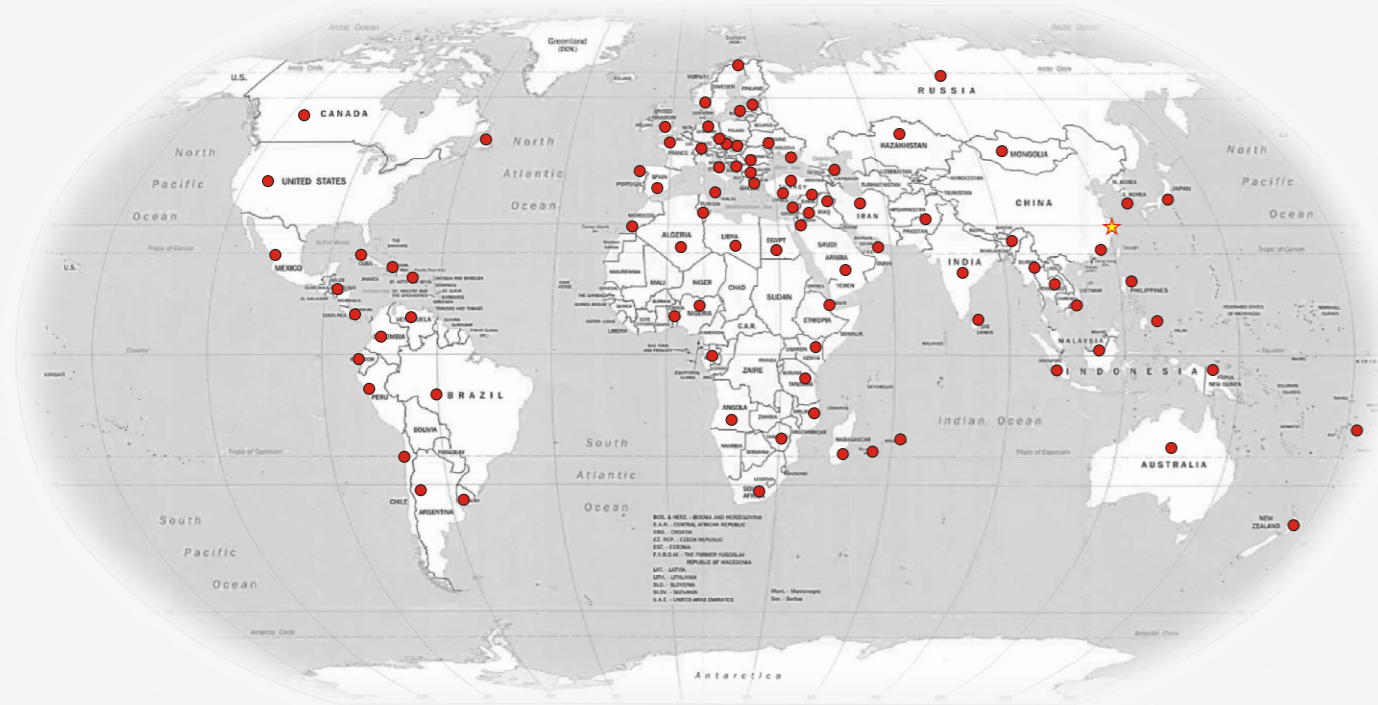

Premium Range Electric Pallet Truck



CE CERTIFICATE



ISO14001

ISO14001: 2004



ISO9001

ISO9001: 2008

HANGCHA GROUP CO., LTD.
(Zhejiang Hangcha Imp.&Exp.Co.,Ltd.)

www.hcforklift.com

Add:398 Shi Qiao Road, Hangzhou Zhejiang province, China(310022)
 Factory site:No.88,Donghuan Rd.,Economic Development Zone Lin'an,Zhejiang,China(311305)
 Tel: +86-571-88926755
 Fax: +86-571-88926789 88132890
 E-mail: sales@hcforklift.com
whsales@hcforklift.com

HANGCHA GROUP CO., LTD. Reserves the right to make any changes without notice concerning colors, equipment, or specifications detailed in this brochure, or to discontinue individual models. The colors of trucks, delivered may differ slightly from those in brochures.

2012 VERSION 1/ COPYRIGHT 2011/09

HANGCHA GROUP CO., LTD.

Durability

Durable frame construction, with integrated welded forks brings the truck high rigidity, and long working life. New butterfly drive controller is more easy for operator. Integrated ZF transmission system, more reliable.

Productivity

Compacted chassis design, makes the truck operated in limited spaces. Powerful AC traction motor with Curtis control system. Applied MOSEFET high frequency control. Germany WICKE wheel. Unique steering pivot design, which makes the drive motor suspends during steering. Shock absorber are standard specification for the caster wheel, prolong the truck's working life time.

Ergonomics

Tiller is ergonomically designed for Max. driver's comfort. Dual lift/lower button controls allow operation by either hand. Creep speed control button is available. Conductor band is standard specification.

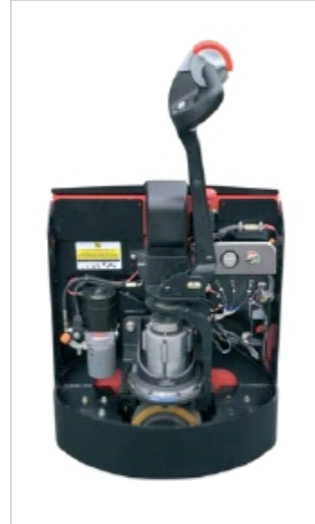
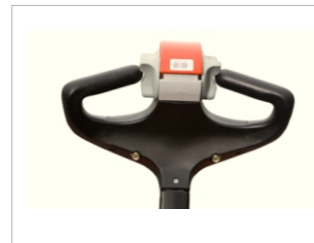
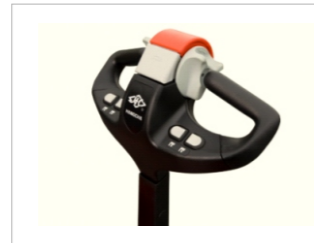

Serviceability

Battery discharge indicator with lifting interrupt as standard specification when 20% battery capacity available and inform the operator of recharge requirement. IP54 environment sealing, which protect the inside components. Open the back cover, every components are easy to reach.

Standard Specifications

- Poly. Drive wheel and load wheels
- AC drive motor and control system
- Emergency cut off switch
- Combined hydraulic unit
- LED panel
- 220Ah battery
- 1150mm fork length with 560mm fork distances

Customer options

- 900mm,1000mm fork length
- 520mm, or 670mm fork distances
- Tandem load wheel
- High frequency auto charger

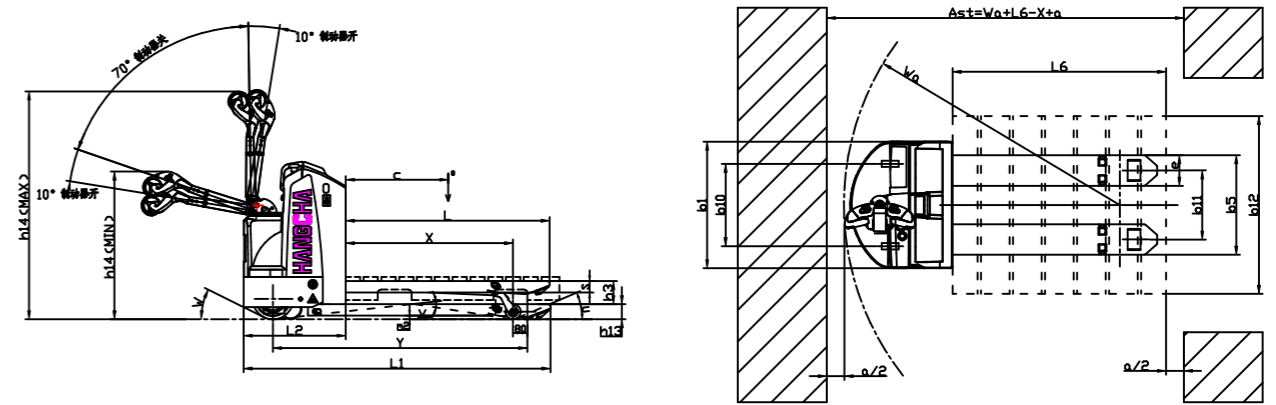

		WHEELBASE TYPE	SINGLE LOAD WHEELS (LONG WHEELBASE)		TANDEM LOAD WHEELS (SHORT WHEELBASE)	
		FORK OAW	560			
		FORK LENGTH	1150			
DISTINGUISHING MARKS	1.1	MANUFACTURER	HANGCHA GROUP CO.,LTD.			
	1.2	MANUFACTURER'S TYPE DESIGNATION	CBD20-TC1			
	1.3	DRIVE	ELECTRIC			
	1.4	OPERATOR TYPE	PEDESTRIAN			
	1.5	LOAD CAPACITY/RATED LOAD	Q (t)	2		
	1.6	LOAD CENTER DISTANCE	c(mm)	600		
	1.8	LOAD DISTANCE	x(mm)	942		
	1.9	WHEELBASE (RAISED)	y(mm)	1352		
	2.1	SERVICE WEIGHT WITHOUT BATTERY	kg	520		
TIRES, CHASSIS	3.1	TIRES	POLY			
	3.2	TIRE SIZE,FRONT	Φ230×75			
	3.3	TIRE SIZE,REAR	Φ85×110	Φ85×90		
	3.4	ADDITIONAL WHEELS (CASTERS)	Φ100×40			
	3.5	WHEEL NUMBER FRONT/REAR(X=DRIVE WHEELS)	1×+2/2	1×+2/4		
	3.6	TREAD,FRONT	b10(mm)	461		
3.7	TREAD,REAR	b11(mm)	390			
DIMENSIONS	4.4	LIFT	h3(mm)	130		
	4.9	HEIGHT OF TILLER IN DRIVE POSITION MIN/MAX	h14(mm)	829/1288		
	4.15	HEIGHT, LOWERED	h13(mm)	83		
	4.19	OVERALL LENGTH	L1(mm)	1728		
	4.20	LENGTH TO FACE OF FORKS	L2(mm)	578		
	4.21	OVERALL WIDTH	b1(mm)	712		
	4.22	FORK DIMENSIONS	s/e/L(mm)	64×172×1150		
	4.25	DISTANCE BETWEEN FORK-ARMS	b5(mm)	560		
	4.32	GROUND CLEARANCE,CENTER OF WHEELBASE	m2(mm)	21		
	4.33	AISLE WIDTH FOR PALLETS 1000×1200 (TRANSVERSE)	Ast (mm)	1960	1915	
	4.34	AISLE WIDTH FOR PALLETS 800×1200 (LENGTH)	Ast(mm)	2007	2008	
	4.35	TURNING RADIUS	Wa(mm)	1549	1503	
PERFORMANCE DATA	5.1	TRAVEL SPEED,LADEN/UNLADEN	km/h	6.0/6.0		
	5.2	LIFT SPEED ,LADEN/UNLADEN	m/s	0.04/0.05		
	5.3	LOWERING SPEED,LADEN/UNLADEN	m/s	0.09/0.04		
	5.7	GRADEABILITY ,LADEN/UNLADEN	%	10.0/15		
		GRADEABILITY	U/V/W(%)	34/15/41		
	5.8	MAX.GRADEABILITY,LADEN/UNLADEN	%	14.5/20		
5.10	SERVICE BRAKE		Electric Magnetic			
ELECTRIC-ENGINE	6.1	DRIVE MOTOR RATING S2 60MIN	kw	1.25		
	6.2	LIFT MOTOR RATING AT S3 15%	kw	1.2		
	6.3	BATTERY ACC.TO DIN 43 531/35/36 A,B,C,NO	CIRCUIT	B		
	6.4	MAX. BATTERY SIZE	L×W×H(mm)	212×624×627		
		BATTERY VOLTAGE , NOMINAL CAPACITY K5	V/Ah	24/220		
	6.5	BATTERY WEIGHT (±5%)	kg	212		
6.6	ENERGY CONSUMPTION ACC. TO VDI CYCLE	kwh/h	0.384			
ADDITIONAL DATA	8.4	SOUND LEVEL AT THE DRIVE'S EAR ACCORDING TO DIN 12 053	dB(A)	< 70		

a=200mm