

Operating Instructions Parts List

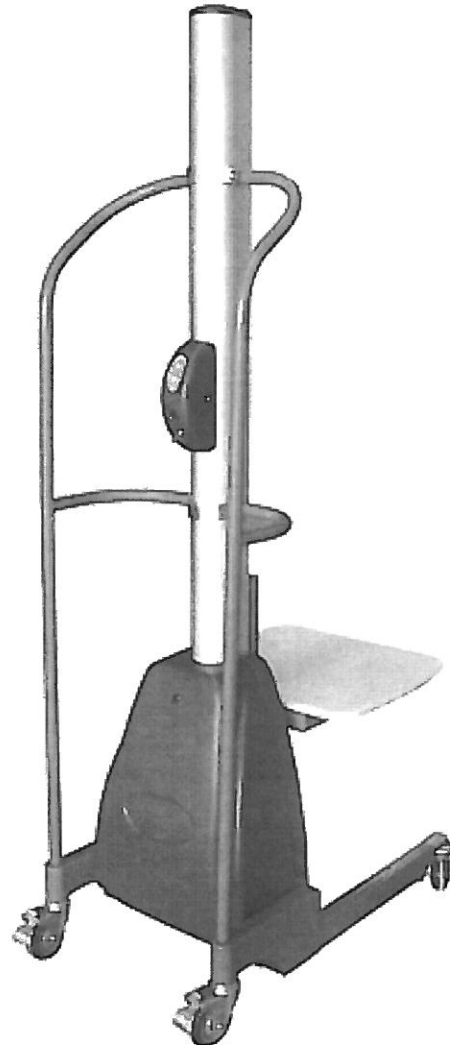

MODEL MES150

Note: Owner and Operator MUST read and understand this operating instructions before use this lifter transporter.

ATTENTION:

1. The worn batteries and accumulators were solid wastes with danger. They are harmful to our health and environment. To avoid polluting with the leaking liquid, we should put the replacements into a special and leak-tight container. To avoid the hurt to people, it should be put away from the place people lived and worked with a warning sticker. The collected worn batteries and accumulators should be handed in to a competent institution according to the local statute.
2. The waste packages should be sorted and put into the solid dustbin according to the materials, and be collected disposal by local special environment-protection bureau. To avoid pollution, it's forbidden to throw away the wastes random.
3. To avoid leaking during the use of the products, the user should prepare some absorbable material (scraps of wooden or dry duster cloth) to absorb the leaking oil in time. To avoid the second pollution to the environment, the used absorbable materials should be handed in to the special department in term of the local statute.

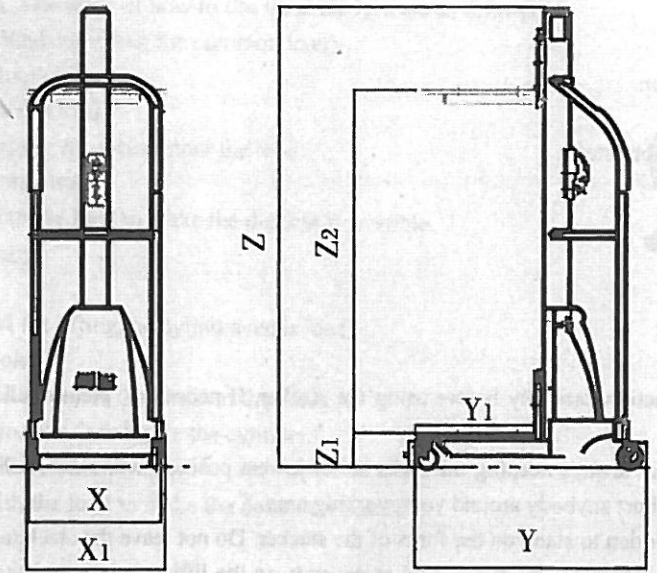

1. TECHNICAL FEATURES

MODEL		MES150
Capacity	Kg	150
Lifting height(h1)	mm	1550
Min .fork height	mm	130
Fork width	mm	330/520
Wheels Q'ty	N	4
Lifting speed	m/s	Without load 83mm/s, with full load 70mm/s
Lowering speed	m/s	Without load 85mm/s, with full load 101mm/s
Battery		7 Ah/12v
Front wheel	mm	Φ 75*32
Rear wheel	mm	Φ 100*32
Transmission		By belt and gear
Weight	kg	58
Dimension (mm)	X	500
	Y	830
	Z	1870
	Z1	140
	Z2	1540
	X1	520
	Y1	460

2. ADHESIVE

REMARKS:

A: Capacity limitation.

B: Warning.

C: Danger! "watch your step".

D: Trademark

E: Switch

F: Recharging

G: Power

3. ADVISES

- 3.1 Read this instruction carefully before using the stacker. If necessary, please call our technical people for assistance.
- 3.2 Move the stacker always keeping the forks at the lowest position while no loading on the forks. Pay attention not to hurt anybody around your working area.
- 3.3 People are forbidden to stand on the forks of the stacker. Do not leave the stacker on the working place after used. The load capacity of the stacker depends on the lifting height and the position of the load center, please refer to the relative technical features in this instruction.
- 3.4 The adhesive label on the stacker must be always legible. Do not use the stacker for purpose except lifting or lowering load.
- 3.5 Do not make casual repair. If repaired by unprofessional people, the safety modulus of the machine could be altered. In case damage happens, repair it in the local place according to the instruction or contact to us.
- 3.6 Carry out all the work and maintenance according to the norms after using it.

4. WORKING NORMS FOR THE OPERATOR

Do not worry about how to operating this stacker, the characteristic of this stacker is facility and easy to operate.

4.1 The two function of the brakes

The rear wheels are equipped with brakes which with two functions, it can control the moving of forward and backward effectively. Step the pedal of the brake backward, the stacker will be braked. Step the pedal of the brake forward, the stacker will travel normally. The stacker should be braked under the condition as following: A, stop at the slope; B, during charging; C, when loading; D, leave unused.

4.2 The forward/backward/swivel of the stacker

Open the brake of the rear wheels, leave the two wheels at the state which can swivel freely. Take hold of the armrest, push the stacker ahead, the stacker can move ahead. In the same way, pull the stacker backward, the stacker will fall back. We use universal wheels on this truck, so it's very easy to swivel and swivel into any direction. It's only need a small space because it can be freely swiveled at the original position. If one of the brake is locked, the stacker will be swiveled on an even keel according to the centre of a circle.

4.3 Lifting and lowering of the forks

Press the button of power to "ON", then press the " \triangleleft " or " \triangleright " to control the lifting and lowering of the stacker. (Attention: Before lifting or lowering the forks with load on the forks, please lock the rear wheels of the stacker to avoid moving of the stacker during lowering and lowering.)

4.4 Load of the stacker

According to the deferent goods, this stacker can use the three kinds of shelves as double forks, single

fork, and platform. The ways of how to use these shelves are as follows:

A. Double forks (be fitted for lifting the common load)

- (1) Drive close to the load.
- (2) Lift the forks below the load.
- (3) Drive forward, bringing the forks under the load.
- (4) Lift the load to get the load.
- (5) Back the stacker with the load to make the descent if possible.
- (6) Lower the load slowly.



B. Single fork (be fitted for lifting the cylindraccous load)

- (1) Drive close to the load.
- (2) Drive the fork to the centre of the circle of the load.
- (3) Drive forward, extend the fork inside the cylinder.
- (4) Lift the load to get the load.
- (5) Back the stacker with the load to make the descent if possible.
- (6) Lower the load slowly.

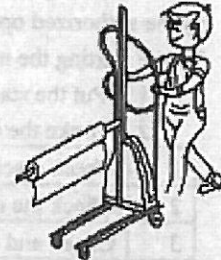

C. Platform (be fitted for the lifting the load with small volume)

- (1) Drive close to the load.
- (2) Lift the platform to a proper position (be convenient for people to stack the goods)
- (3) Transfer the goods to the platform artificially.
- (4) Lower the platform.

Attention: If possible, the platform with load can be lifted as the double forks.



4.5 The steps of unloading the goods

A. Double forks/ single forks

- (1) Get close to the position.
- (2) Lift the load up to the desired height position.
- (3) Advance slowly to bring the load to the proper position.
- (4) Lower the load to make the bottom of the forks on the shelf.
- (5) After unloaded, back the forks slowly.

B. Platform

- (1) Drive the stacker with load to the destination, and lock the rear wheels.
- (2) Lift the platform to a proper height for people to unload it.
- (3) Unloading.

5. RECHARGE OF BATTERY

The batteries of the stacker must be recharged with a constant continuity, and the recharging should be very timely.

When recharging, switch off the power. Connect the charger to the power supply, and insert the plug of the charger into the recharging faucet of the stacker, press the switch of charger, recharging will begin.

When recharging is over, the charger will stop automatically.

6. DAILY MAINTENANCE

The daily maintenance is a responsibility of the operator of the stacker. The main functions that must be checked are as follows:

1	Check the retarder of the motor.
---	----------------------------------

2	Check the forks.
3	Check the swivel wheel.
4	Check the transmission belt.
5	Check the charger.

7. PROGRAMMED MAINTENANCE

In the following we show a table in which there are some tips about the programmed maintenance done by the authorized operators.

Before starting the maintenance you have to:

1. Put the stacker on an even and solid surface.
2. Brake the both rear wheels.

1	Check electrical systems, cleaning with air or with a brush and special detergent
2	Check the connections of the conductors.
3	Check and clean the driving-wheel group.
4	Check the wear of rollers and wheels.
5	Check movements and wears between masts and rollers with bearings.
6	Check and tighten all the screws and nuts.
7	Complete greasing of the stacker, bearings and sliding masts.

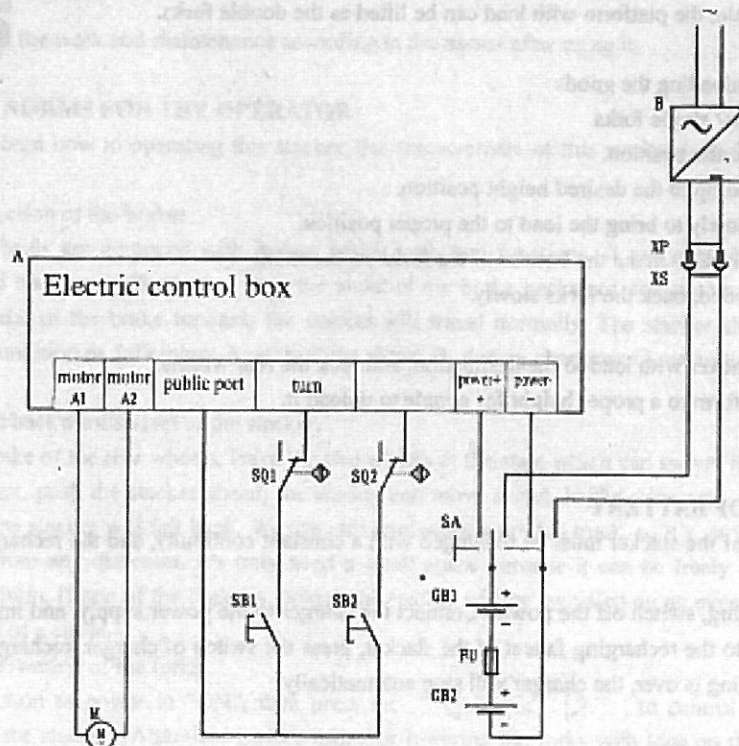

CIRCUIT DIAGRAM OF MES150

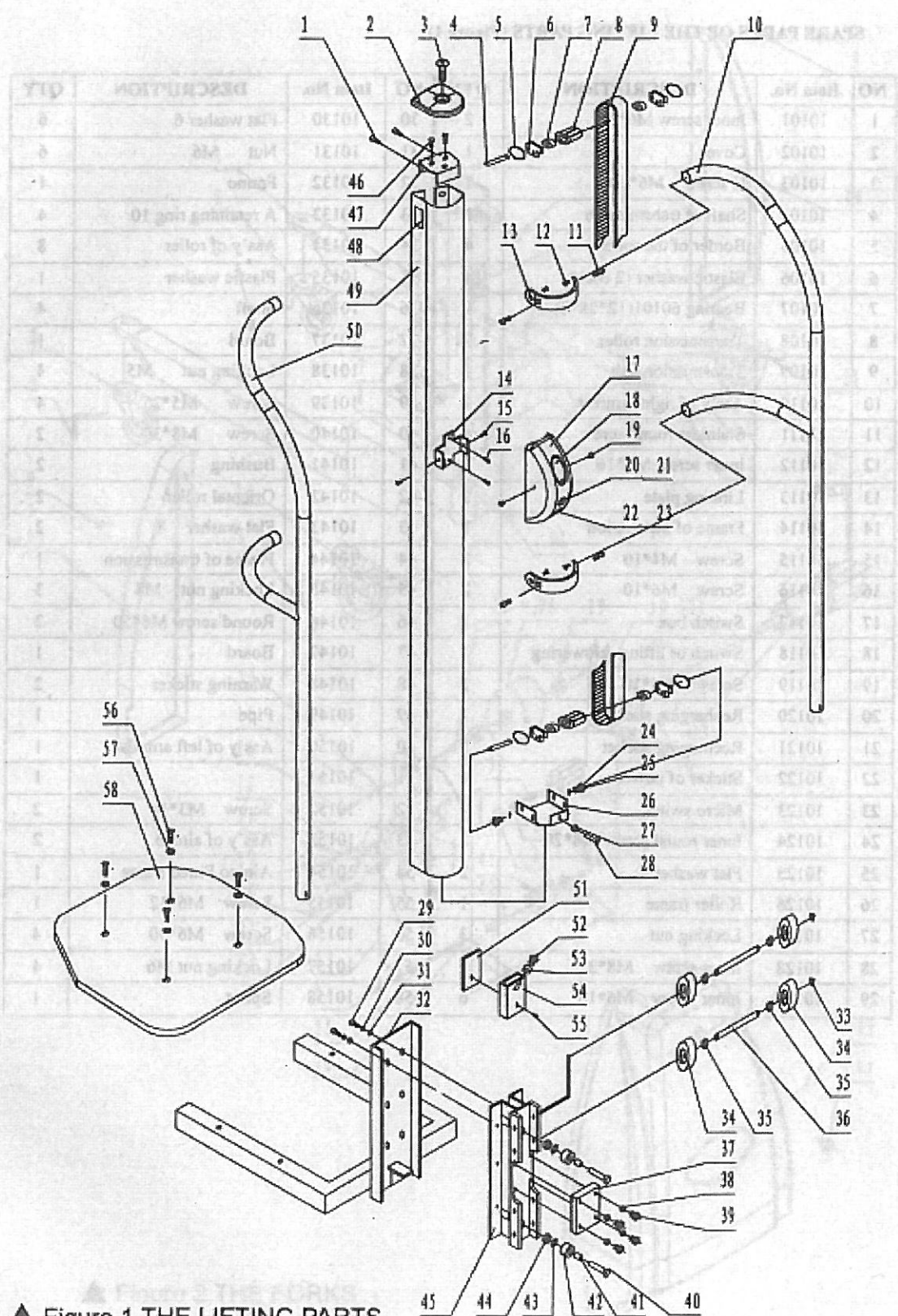

▲ Figure 1. THE LIFTING PARTS

SPARE PARTS OF THE LIFTING PARTS (Figure 1)

NO	Item No.	DESCRIPTION	QTY	NO	Item No.	DESCRIPTION	QTY
1	10101	Inner screw M6*10	2	30	10130	Flat washer 6	6
2	10102	Cover	1	31	10131	Nut M6	6
3	10103	H screw M6*10	1	32	10132	Frame	1
4	10104	Shaft of transmission	1	33	10133	A retaining ring 10	4
5	10105	Border of the roller	4	34	10134	Ass'y of roller	8
6	10106	Elastic washer (2 each)	4	35	10135	Plastic washer	1
7	10107	Bearing 60101(12*28*8)	1	36	10136	Shaft	4
8	10108	Transmission roller	2	37	10137	Board	1
9	10109	Transmission belt	1	38	10138	Locking nut M5	4
10	10110	Ass'y of right armrest	1	39	10139	Screw M5*25	4
11	10111	Stainless round screw	4	40	10140	Screw M8*30	2
12	10112	Inner screw M8*16	4	41	10141	Bushing	2
13	10113	Linking plate	2	42	10142	Oriental roller	2
14	10114	Frame of installation	1	43	10143	Flat washer 8	2
15	10115	Screw M4*10	2	44	10144	Frame of transmission	1
16	10116	Screw M6*10	2	45	10145	Locking nut M8	3
17	10117	Switch box	1	46	10146	Round screw M6*50	2
18	10118	Switch of lifting & lowering	1	47	10147	Board	1
19	10119	Screw M4*10	2	48	10148	Warning sticker	2
20	10120	Recharging sticker	1	49	10149	Pipe	1
21	10121	Recharging socket	1	50	10150	Ass'y of left armrest	1
22	10122	Sticker of power	1	51	10151		1
23	10123	Micro switch	1	52	10152	Screw M3*10	2
24	10124	Inner round screw M8*20	2	53	10153	Ass'y of alnico	2
25	10125	Flat washer 8	2	54	10154	Alnico Fitted frame	1
26	10126	Roller frame	1	55	10155	Screw M6*12	1
27	10127	Locking nut	3	56	10156	Screw M6*30	4
28	10128	Inner screw M8*25	1	57	10157	Locking nut M6	4
29	10129	Inner screw M6*16	6	58	10158	Splint	1

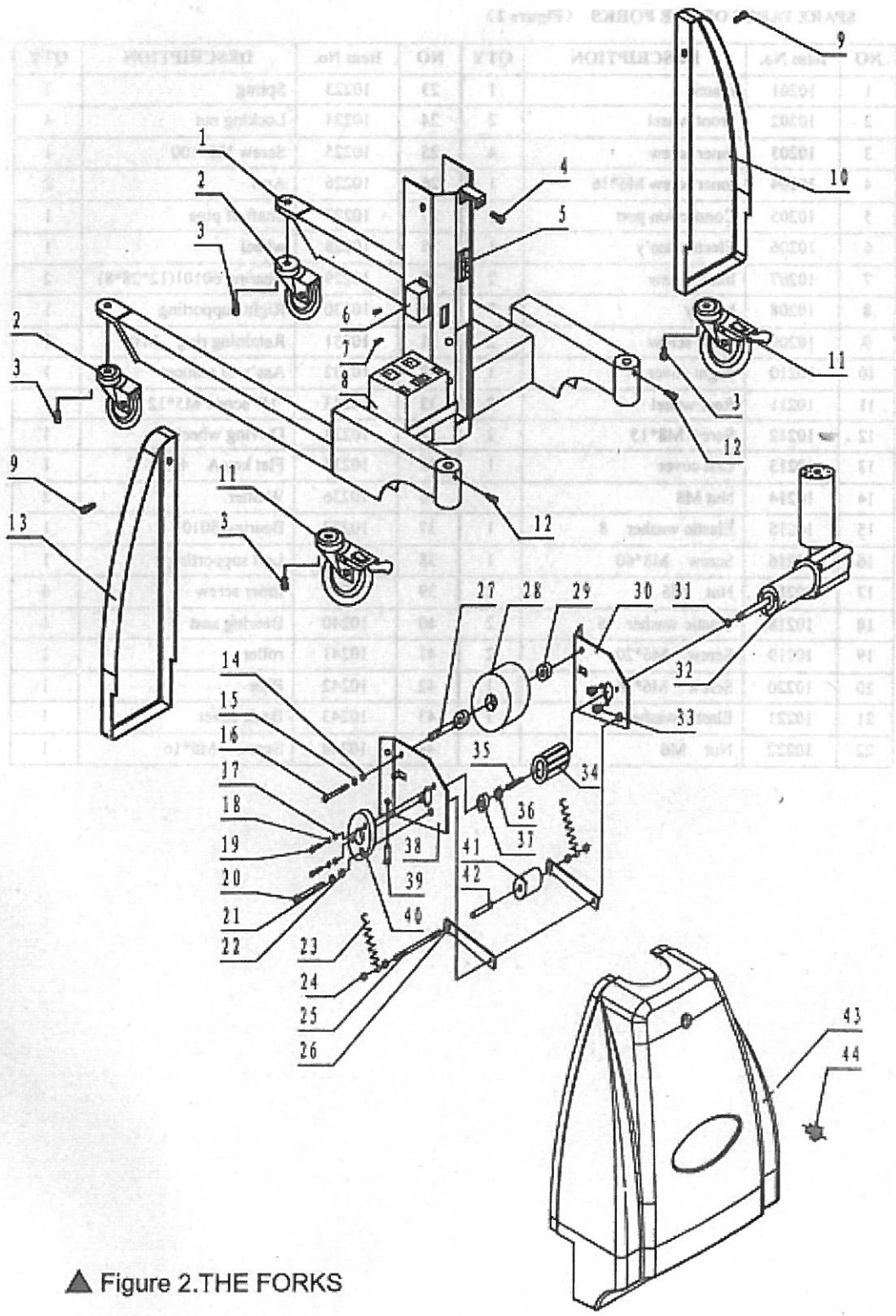

▲ Figure 2. THE FORKS

SPARE PARTS OF THE FORKS (Figure 2)

NO	Item No.	DESCRIPTION	QTY	NO	Item No.	DESCRIPTION	QTY
1	10201	Frame	1	23	10223	Spring	2
2	10202	Front wheel	2	24	10224	Locking nut	4
3	10203	Inner screw	4	25	10225	Screw M6*100	1
4	10204	Inner screw M6*16	1	26	10226	Arm	2
5	10205	Connection port	1	27	10227	Shaft of pipe	1
6	10206	Electric ass'y	1	28	10228	wheel	1
7	10207	Inner screw	2	29	10229	Bearing 60101(12*28*8)	2
8	10208	battery	2	30	10230	Right supporting	1
9	10209	Inner screw	2	31	10231	Retaining ring M10	1
10	10210	Right cover	1	32	10232	Ass'y of reducer	1
11	10211	Rear wheel	2	33	10233	"H" screw M5*12	3
12	10212	Screw M8*15	2	34	10234	Driving wheel	1
13	10213	Left cover	1	35	10235	Flat key A 4*38	1
14	10214	Nut M8	1	36	10236	Washer	2
15	10215	Elastic washer 8	1	37	10237	Bearing 80101	1
16	10216	Screw M8*60	1	38	10238	Left supporting	1
17	10217	Nut M6	2	39	10239	Inner screw	4
18	10218	Elastic washer 6	2	40	10240	Bearing seat	1
19	10219	Screw M6*20	2	41	10241	roller	1
20	10220	Screw M6*86	1	42	10242	Pipe	1
21	10221	Elastic washer 8	1	43	10243	Back cover	1
22	10222	Nut M6	1	44	10244	Screw M6*16	1

