

SIT-ON STACKER

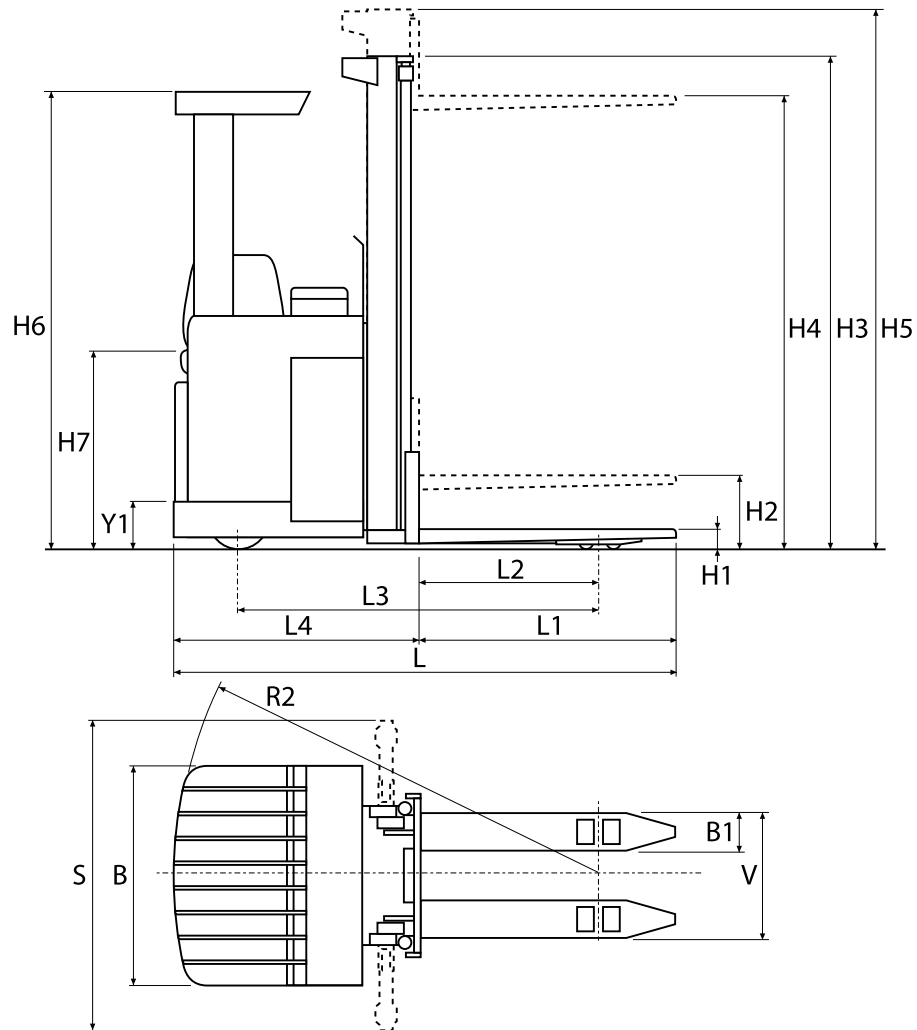

ERGO XSN 160SDTFV

The most economical, comfortable and productive stacker for long work cycles; remarkably compact with high handling efficiency. Many options available.



Mast type	Standard lift height H4	Min mast height H3	Max mast height H5
Telescopic			
Double telescopic	4350 4800 5400 5700 6300	1990 2140 2340 2440 2640	4862 5312 5912 6212 6812

ATLET

www.atlet.com

					ERGO XSN 160SDTFV
Lift capacities	0	Specification			
	0a	Straddle leg position			Narrow
	1	Lift capacity	Q	kg	1600
	1a	Load centre	D	mm	600
	2	Lift height	H4	mm	See table
	2a	Mast height	H3/H5	mm	See table
	2b	Transport free lift	H2 T mast	mm	
	2c	Full free lift	H2 DT mast	mm	H3-477
	2d	Straddle lift		mm	
	3	Mast tilt. Forward - backward			
3a	Tilting forks. Forward - backward				
4	Lift speed. Without load - with normal load		m/s	0,27-0,15 / 0,33-0,17	
4a	Lift time. Without load - with normal load		s		
4b	Lift speed, ergolift. Without load - with normal load		m/s		
5	Lowering speed. Without load - with normal load		m/s	0,30 - 0,60	
5a	Lowering time. Without load - with normal load		s		
Drive capacities	6	Drive speed. Without load - with normal load		km/h	10-8,5 / 11-8,5
		Drive speed. Without load - with normal load		m/s	2,8-2,4 / 3-2,4
	6a	Acceleration 0-10 km/h			
		Without load - with normal load		s	
	8	Gradient, without load / with normal load	max	%	7
	10	Turning radius	R2	mm	1897
	11	Smallest practical stacking aisle incl 200 mm play			
		Load length 1200 mm	Ast	mm	2497
		Load length 1000 mm	Ast	mm	2297
		Load length 800 mm	Ast	mm	2097
	Aisle width requirement according to BITA GN9 UK market only	A1	mm		
		A2	mm		
		A3	mm		
	Smallest practical stacking aisle with pallet LL 1200 with the platform				
	folded up/folded down	Min	mm		
11a	Intersecting aisle width. Load length 1200 mm	Min	mm		
11c	Max load length	LL	mm		
11d	Max load width	LB	mm		
Truck measurements	13	Height of overhead guard	H6	mm	2110
	13a	Height of driver seat	H7	mm	900 - 1000
	13b	Step-in height	Y1	mm	350 - 430
	13c	Floor height		mm	
	13d	Width of open gate		mm	
	14	Truck length	L	mm	2247
	15	Truck width	B	mm	1010
	15a	Width over guide wheels	A	mm	
	15b	Width over stabilisers	S	mm	1415
	15c	Platform length		mm	
	15d	Platform width	B3	mm	
	15e	Height of platform gates		mm	
	16	Fork length	L1	mm	1000 / 1150
	17	Width over forks	V max/min	mm	560
	17a	Width between forks		mm	220
	18	Reach length	U	mm	
	19	Distance from back plate to retracted fork heel	L4 T-mast	mm	1097
		Distance from back plate to retracted fork heel	L4 DT-mast	mm	
	20	Fork arm, width - thickness	B1	mm	170 - 70
	20a	Fork height, min	H1	mm	89
21	Straddle height	H8	mm	80	
22	Width between straddles	B2	mm	265	
22a	Width over straddles		mm	515	
23	Distance between front axle and retracted fork heel	L2	mm	800	
23a	Distance between front axle and centre of attachment	L2	mm		
23b	Distance between front axle and heel of extended fork	X1	mm		
24	Axle distance	L3	mm	1704	
25	Wheel track, front rear (centre lines wheels)		mm	390 - 685	
26	Ground clearance at half axle distance		mm	25	
Weights	27	Total weight with-without battery.		kg	1975 - 1375
	28	Max axle pressure, fork side, without/ with classified load		kg	500 / 1980
	29	Max axle pressure, drive side, without/with classified load		kg	1270 / 1430
	30	Max wheel point loading, without/with classified load		MPa	
Motors	39	Battery capacity		kWh/Ah	13,4-18 / 560-750
	39a	Battery voltage		V	24
	41	Drive motor		kW	2,4 AC
	42	Speed regulation			Transistor
	43	Lift motor. Output/Interm. conn.time		kW-%/min	4,5-12/10 / 7,6-12/10
43a	Hydraulic pressure		MPa	17,5	
Steering/brake system	44	Wheel type, drive wheel/others			Rubber/Vulcollan
	44a	Number of wheels, drive/castor - load wheels			3 - 4
	45	Wheel dimensions			
	45a	Load wheels - diameter x width		mm	(4) x 85x75
	45b	Drive wheel - diameter x width		mm	(1) x 250x80
	45c	Castor wheels - diameter x width		mm	(2) x 150x60
	46	Steering			El. servo
	47	Service brake - Type-acting on			El. - drive motor
48	Parking brake - Type-acting on.			Mech. - drive motor	

2009-04-03

* Varies according to battery size

All rights reserved to change above specification